

Order no.: 272312

**Techn. Values:**

Designation:	MHR 150 N/B
Wattage (W):	150
Lamp current (A):	1,8
Voltage (V):	95
Luminous flux (lm):	4500***
Colour temperature (K):	4200
Diameter (mm max.):	95
Length (mm max.):	94
Luminous flux1 (lm):	2000
Luminous flux2 (lm):	6800
Focal distance (mm):	61
Base:	Stecker 2-polig
Average life (h):	6000
Burning position:	p10
Packing unit:	1
Ra-Value:	85

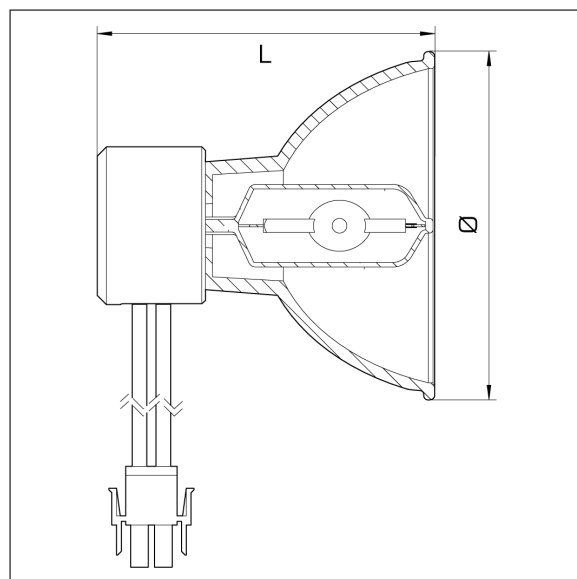

p10

**ADVANTAGES:**

- Simple lamp exchange without readjustment
- Cool beam effect
- High efficacy because of a short axial arc and optimal lamp adjustment
- Ideal for use with plastic fibres with small fibre diameters
- Can be used with standard metal-halide lamp ballasts and ignitors
- Hot re-ignition possible (MHR 100 D/HR and MHR 150 N)
- Lamps with thermo-couple available on request

**APPLICATION:**

in decorative areas, e.g.:

- Architecture
- Interior lighting
- Fountains and swimming pools